

the lay-out of a number of houses constructed in this period. This new differentiation marked the end of differences not only between the dominant Barghouthi and the subordinate fallaheen, but also the end of the specificity of Palestinian rural architectural forms as opposed to the urban cosmopolitan forms (fig. II.16). Today the city has become the "generator" of styles. The rural professionals and peasant elite ape the urban bourgeoisie in a peasant eclectic manner. The differentiation between the two is no longer of peasant and urban culture, but one of class.

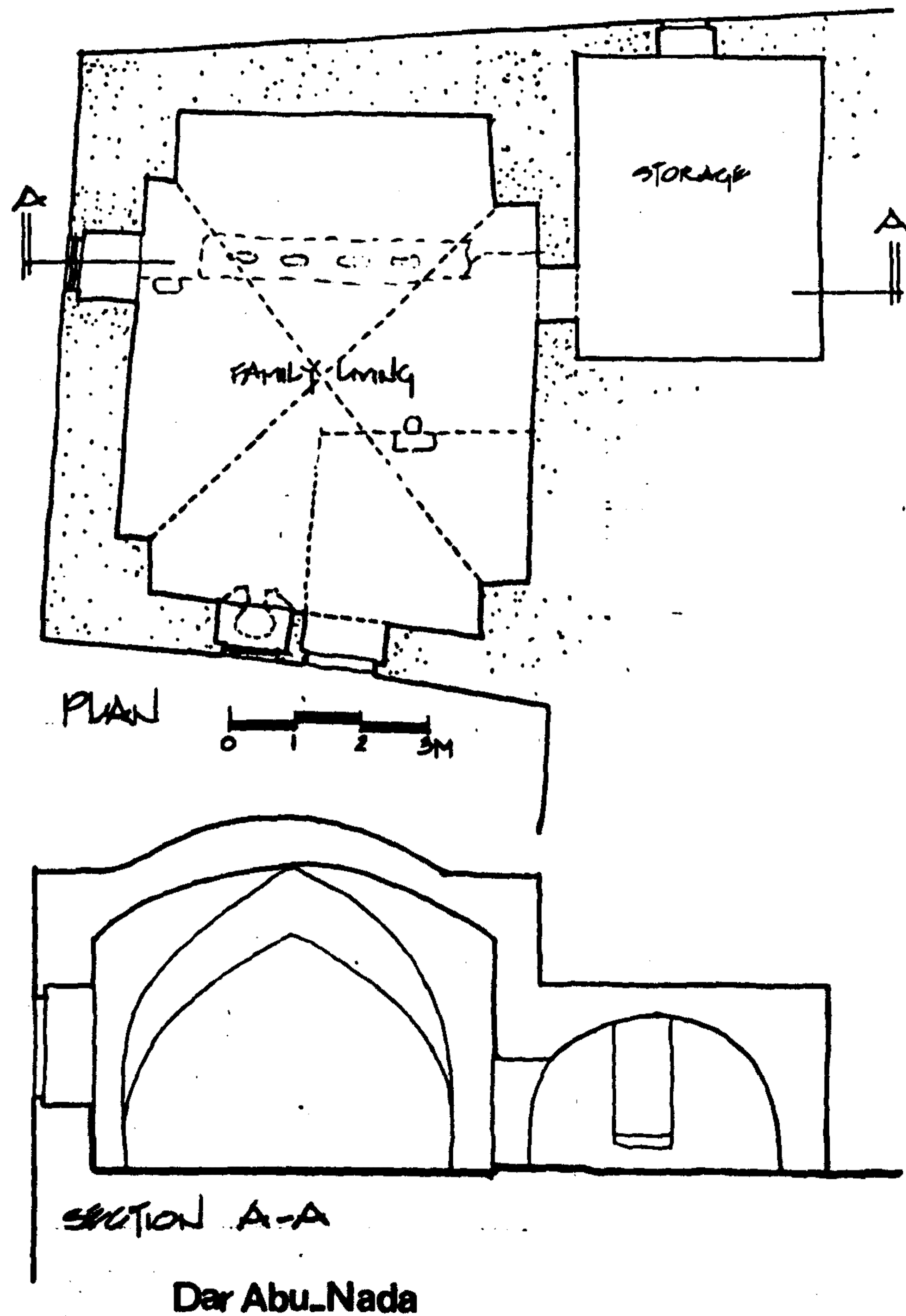

Fig. II.12: The disappearance of animal and agricultural produce areas (qa' el-beit and er-rawieh)